

February 2021

Ref:	V 1.9
Product Family:	BigBaler
Product Range:	Application

### 7 Series Automatic Applicator



MODEL	LB324/LB334 Packer	LB324/334 RotorCutter	LB424/LB434 Packer	LB424/LB434 RotorCutter	LB436 HD RotorCutter
PFC-796BB4533C	X				
PFC-796BB4534C			X		
PFC-796BB4635C		X			
PFC-796BB4636C				X	
PFC-795BB4636C					X

Andrew Snell  
+44 (0) 7967 300578  
Andrew@pfc-eu.com

LB  
All Models



### Moisture Sensor

The system utilises electrical conductivity between measuring star wheels either side of the bale chamber

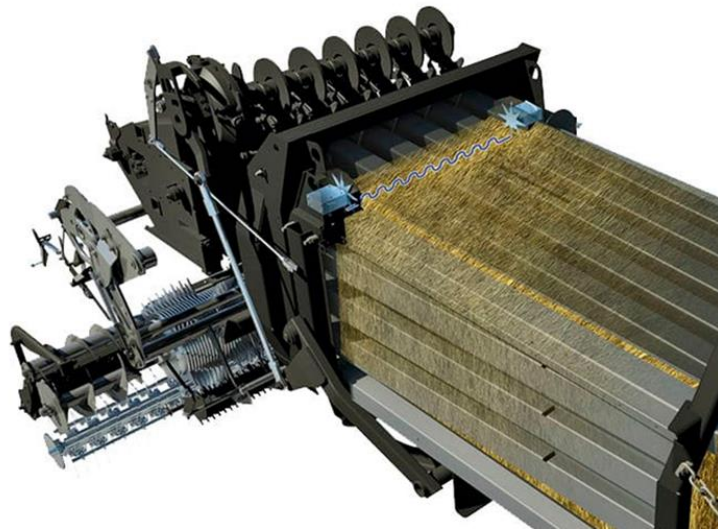

### Features

- **INTEGRATION**
  - Electronically through the balers CANBUS
  - Live and average humidity shown via the baler's terminal
  - Baler is factory prepared for mechanical and electrical installation
- Working range between 8 - 70% humidity
- Accuracy +/- 1% < 35% humidity
- 9 measurements per second
- Humidity is measured through the profile of the slice to achieve high levels of accuracy.

Andrew Snell  
+44 (0) 7967 300578  
Andrew@pfc-eu.com

LB  
All Models

**CASE IH**  
AGRICULTURE

# **THIRTYPLUS<sup>TM</sup>**

## **SALES & PRODUCT INFORMATION**

### **Automatic Applicator**

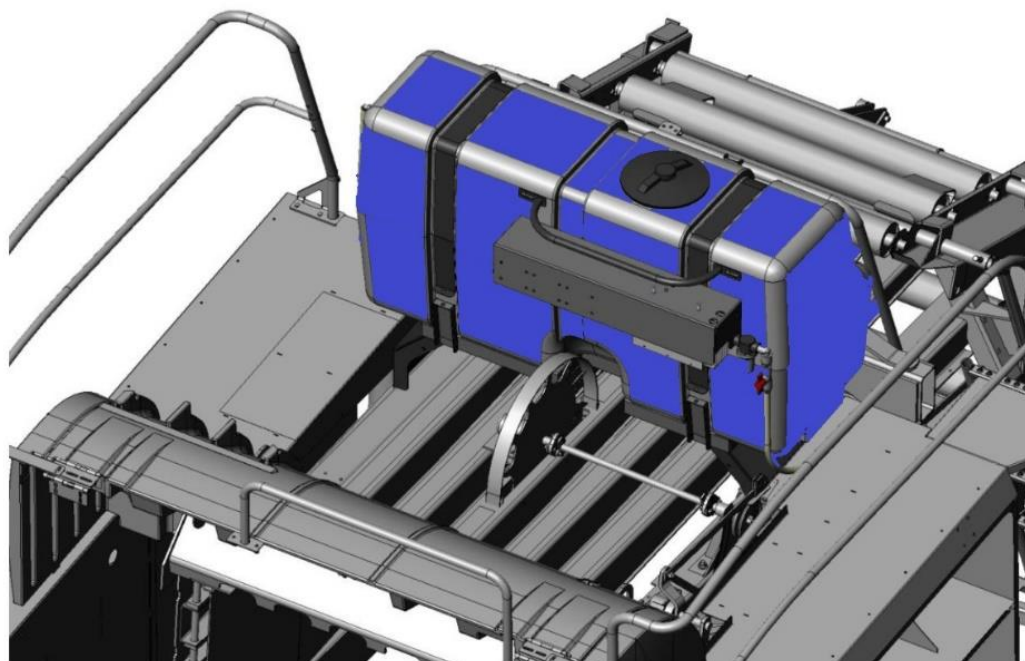

### **Features**

- Mounts directly to factory engineered locations
- 435 litre tank
- Single high-capacity pump and flow meter
  - 6.6 L/Min (400 L/Hour) restricted flow
  - Twin solenoid rate control
  - 4 nozzles (2 nozzles/solenoid)
  - Recommended for Inoculants and CropSaver hay preservative
- Automatic adjustment of application rates for humidity, bale weight and tonnes/hour with a baler equipped with Actiweigh and electronic bale length
- Information shown via IntelliView terminal
- Individual bale job records

Andrew Snell  
+44 (0) 7967 300578  
Andrew@pfc-eu.com

**LB**  
**All Models**

**CASE II**  
AGRICULTURE

# THIRTYPLUS™

## SALES & PRODUCT INFORMATION

### Additional Standard Features

- Twin Solenoids
- Linked to the IPM for complete rate control
- Instant pulse rate adjustment
- Zero leak for non-drip nozzle function
- Controls flow from 0.5 - 6.6 L/Min

### Crop Eyes

- Infra-Red signal
- Monitor crop flow over the pickup
- Automatically starts and pauses the pumping system

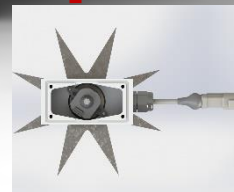
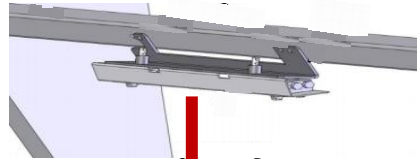
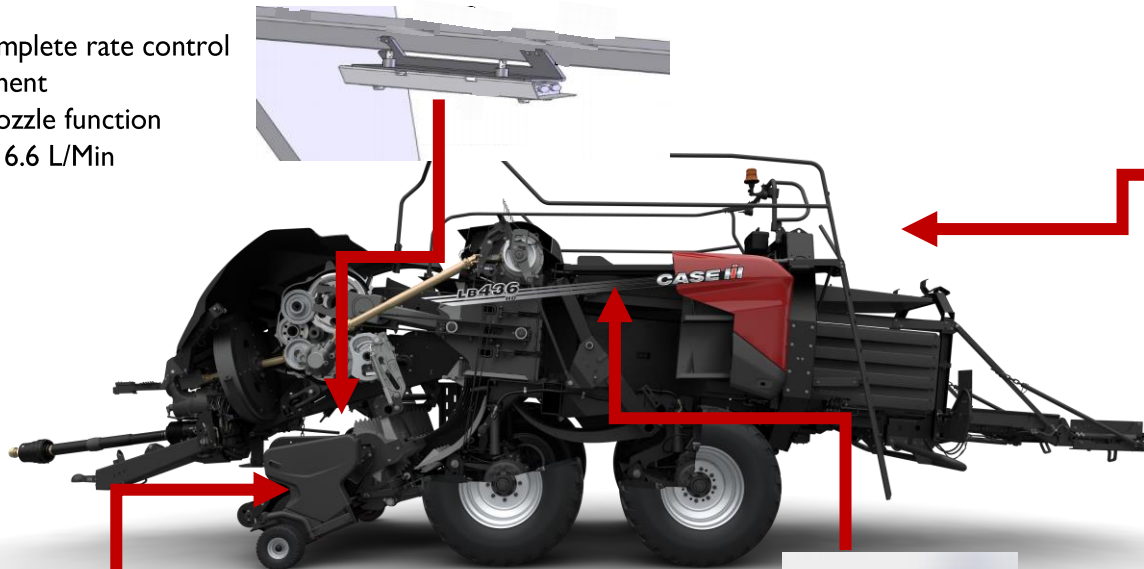

### Camera and Work Light Bracket

- Allows relocation of work lights and camera

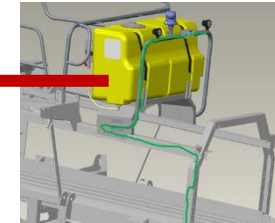

### Star Wheel Encoder

- Built into the star wheel housing
- Monitors baler output
- Responds rapidly to baler output changes

Andrew Snell  
+44 (0) 7967 300578  
Andrew@pfc-eu.com

LB  
All Models

**CASE II**  
AGRICULTURE

## SALES & PRODUCT INFORMATION

### Benefits – Moisture Sensor

- NO Calibration of moisture sensor when changing crops and bale density
- Extended working day = More bales
- Non-stop baling = More bales
- Moisture accuracy = High quality bales

### Benefits – Automatic Applicator

- Extended working day = More bales
- Non-stop baling = More bales
- Using CropSaver hay/straw preservative = High quality bales
- Reduced
  - Tedding passes
  - Days to make quality hay
  - Hay spoilage (using CropSaver preservative)
  - Bale closer behind the combine
  - Baling straw quicker after rain

### Available Options

- Wet bale paint marker system
- On the move Relative feed value analysis in Lucerne crops (weigh scale baler)
- Transfer pump
  - Safe filling of tank from ground level

Andrew Snell  
+44 (0) 7967 300578  
Andrew@pfc-eu.com

LB

All Models

